



FORMWORK & SCAFFOLDING EXPERT
ECO-SMART CONSTRUCTION
1+N INTEGRATED SOLUTIONS

Chinese Listed Company
Stock Code: SZ 300986

PROTECTION SCREEN

防护屏

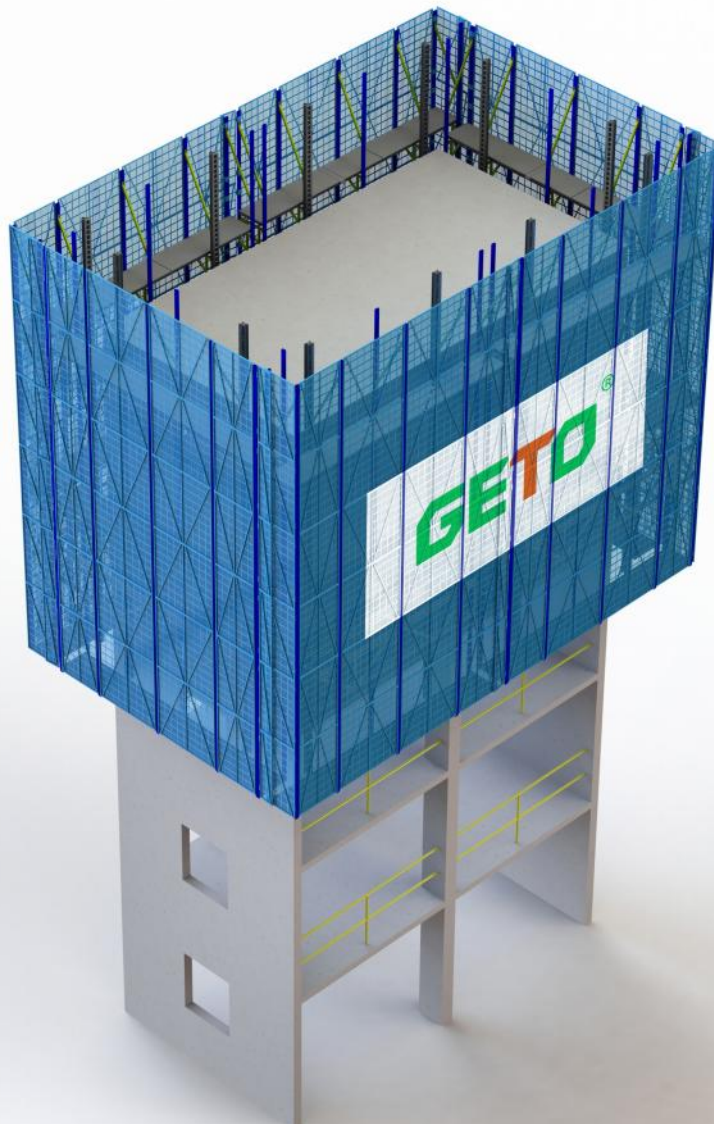

COMPANY PROFILE

企业介绍

GETO Group is mainly engaged in Green new building formwork and scaffolding (aluminium formwork, steel formwork, steel-framed timber formwork, climbing systems, fair-faced concrete formwork, and infrastructure formwork and scaffolding products), Prefabricated buildings (steel structures and PC), Modular housing (steel structures and PC), and Construction & decoration materials (tiles, doors & windows, lighting, custom furniture, etc.)

GETO also provides New energy including the investment, EPC construction, and operation of commercial and industrial "Photovoltaics, Storage, and Charging" projects, while providing the "Green Energy Future Living" one-stop residential energy solution.

In 2021, GETO was listed on the ChiNext board of the Shenzhen Stock Exchange in China (Stock Code: SZ 300986). We have established 12 production bases globally and registered the "GETO®" international trademarks in 32 countries and regions, with products and services reaching worldwide markets.

志特集团主营绿色新型建筑模架（铝模、钢模、钢框木模、爬升式模架、清水混凝土模架及公基建专用模架）、装配式建筑（钢结构与PC）、模块化房屋（钢结构与PC），以及各类结构和装修建筑材料（瓷砖、门窗、灯饰、定制家具等）。

志特还提供相关新能源，包括工商业“光、储、充”项目投资、EPC建设、运维，“绿能未来居”一站式家庭能源解决方案。

“志特新材”于2021年在A股创业板上市（股票代码：SZ 300986），目前已在全球设立12大生产基地，在32个国家和地区注册了“GETO®”国际商标，产品和服务遍及全球。



CONTENTS

目录

01 PROTECTION SCREEN INTRODUCTION

防护屏介绍

Protection Screen Profile 防护屏简介	P08
Features and Advantages 特点和优势	P09
Product Components 产品构件组成	P14
Surface Treatment of Components 产品构件表面处理工艺	P20

02 PRINCIPLES AND PROCESS OF CLIMBING

爬升原理与流程

Principles of Climbing 爬升原理	P24
Process of Climbing 爬升流程	P25

03 SPECIAL POSITION SOLUTIONS

特殊位置处理方式

Tower Crane Attached Arm 塔吊附臂	P36
Elevator 电梯	P38
Loading Platform 卸料平台	P39

Bay Window Attachment 飘窗附着	P40
Floor Attachment 板面附着	P41
Floor Elevated Attachment 板面垫高附着	P42
Structure Overhead Attachment 架空位置附着	P43
Attached Hoop for Steel Column 钢结构柱子抱箍附着	P44
Knotting Measure for Top Cantilever of the Structure 架体顶部悬臂拉结	P45
Attachment of the Inclined Facade 倾斜外立面附着	P46

04 PROJECT CASES

项目案例

PROJECT CASES 项目案例	P50
-----------------------	-----

01.

PROTECTION
SCREEN
INTRODUCTION
防护屏介绍

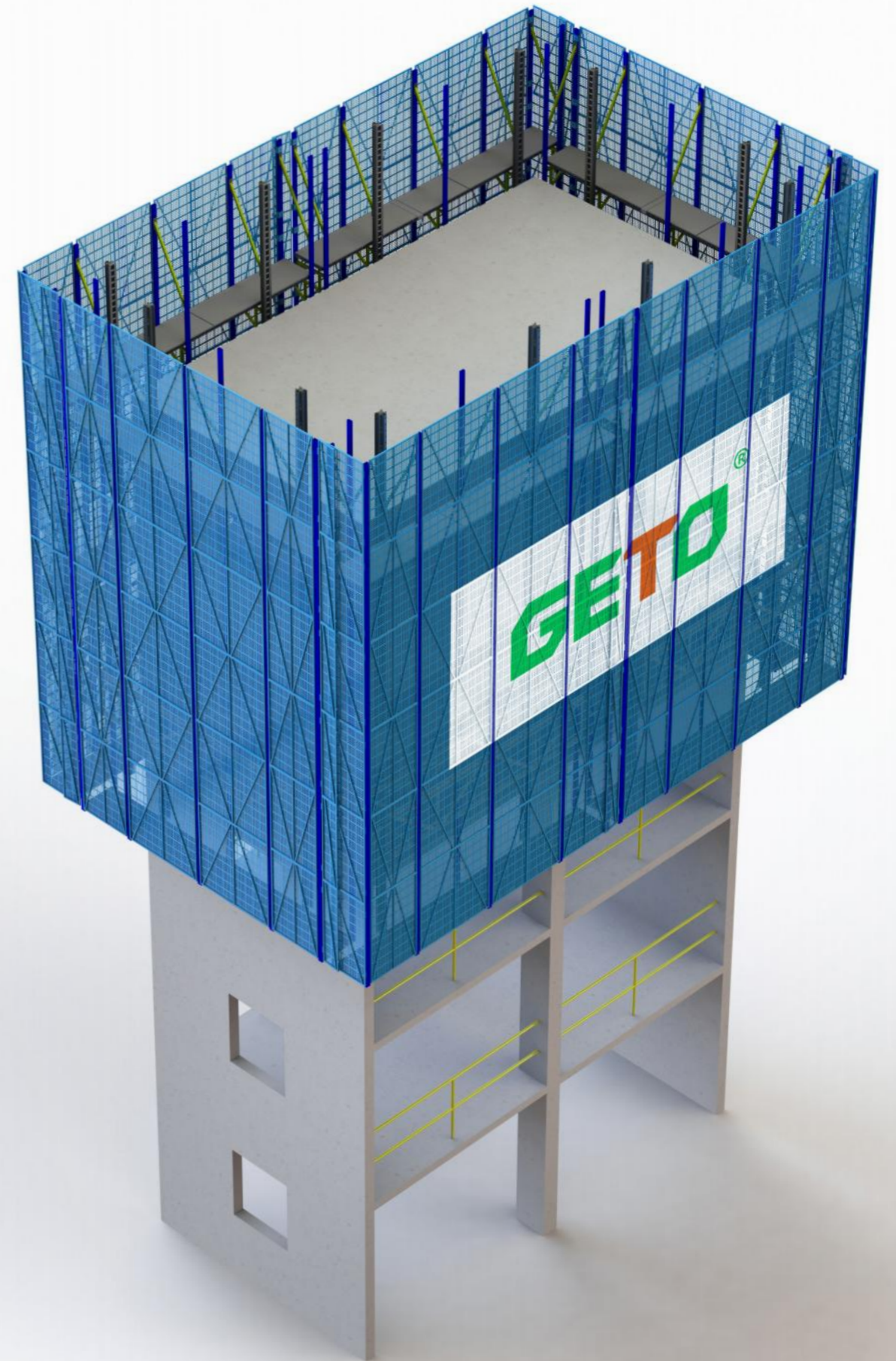

PROTECTION SCREEN PROFILE 防护屏简介

Protection screen is an innovative safety device attached to structures (floors, beams, or walls) and lifted using a tower crane or hydraulic system. Specifically designed to fulfill peripheral protection needs for high-rise, super high-rise, and prefabricated buildings.

防护屏是一种附着在结构上（楼板、梁或墙体），通过塔吊或液压系统进行提升的新型安全防护装置。主要适用于高层、超高层建筑结构及装配式建筑的外围施工防护。

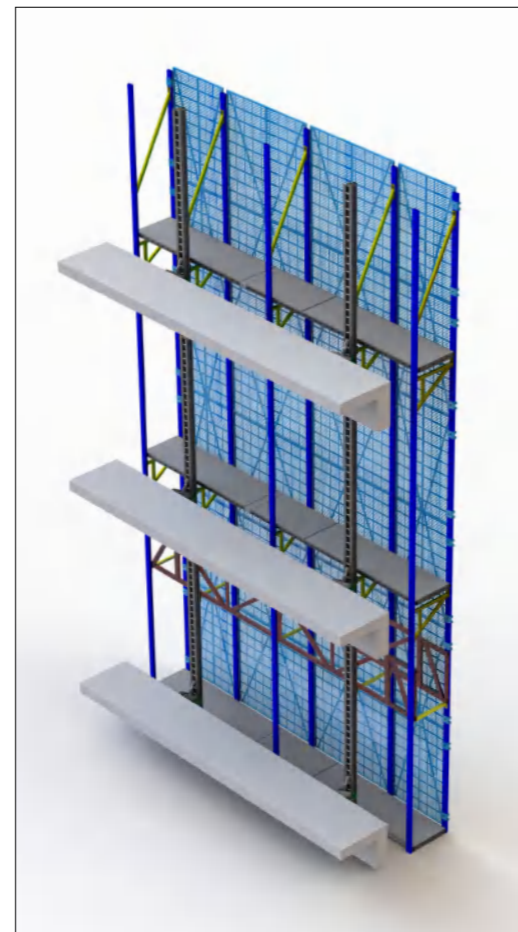
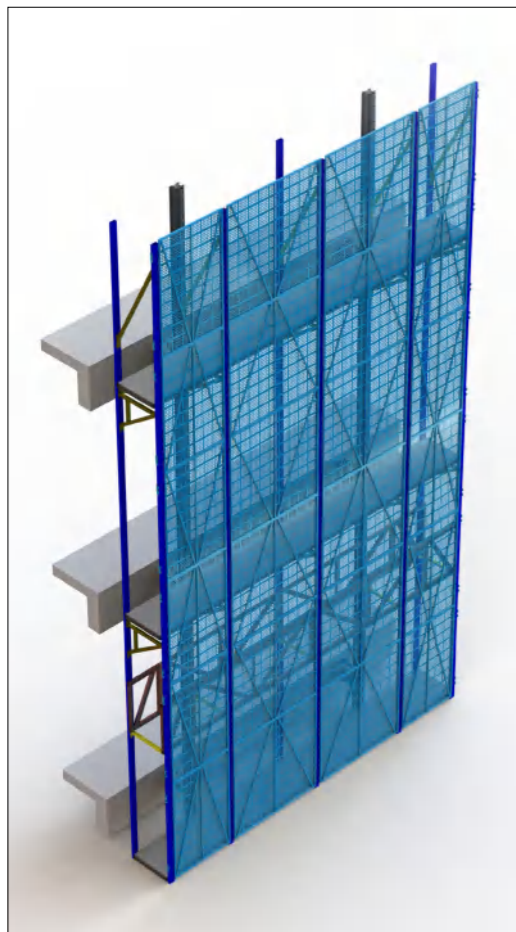

FEATURES AND ADVANTAGES 特点与优势

FEATURES / 特点

- 1 Configured in 2-4 bay modular groupings, with options for hydraulic lifting or tower crane lifting, ensuring high mobility and flexible adaptation.
2-4 个机位分组，可选择液压提升或塔吊提升，具备高机动性与灵活适配性。
- 2 Available in 2.5, 3.5, and 4.5-floor protection heights, which can be freely combined for versatile application across different construction stages.
提供 2.5 层、3.5 层、4.5 层防护，可自由组合，灵活使用，满足不同施工阶段。
- 3 Guide rails and platform boards are 0.3m from the wall for easy installation of beam and wall formwork.
导轨和平台板与墙面净距为 0.3m，便于梁、墙模板支设。
- 4 Sealed flaps can be installed as needed.
可以按需设密封翻板。

ADVANTAGES / 优势

- 1 **High safety / 安全性高**
High wind resistance:
Capable of withstanding a maximum wind load of 9 levels without extra reinforcement. Additional reinforcement is needed for wind loads beyond level 9.
高抗风性：
可承受最大 9 级的风荷载，无需额外加固。超过 9 级的风荷载，需要额外加固。

FEATURES AND ADVANTAGES 特点与优势

ADVANTAGES / 优势

① High safety / 安全性高

Case: Designed with consideration for various regional climates, our protection screen assure normal operation in most weather conditions and safety in extremes. In the implementation of the protection screen project in the Kuala Lumpur, Malaysia, historical wind speed data from 2012 to 2023 was analyzed. It was found that only on December 12, 2015, did the wind speed exceed 83.5 kilometers per hour (Level 9). In most other years, extreme wind speeds did not surpass 80 kilometers per hour. In this region, ensuring safety against wind speeds of level

案例: 我们会根据不同地区气候特点进行针对性设计, 以确保防护屏可以在绝大多数天气正常使用, 并确保在极端天气情况下的安全性。以吉隆坡地区实施防护屏项目为例, 查询马来西亚吉隆坡地区 2012-2023 年的历史风速数据, 仅在 2015 年 12 月 12 日风速超过 83.5 公里 / 小时 (9 级)。在大多数其他年份, 极端风速不超过 80 公里 / 小时, 在此地区, 按 9 级风计算, 确保安全。

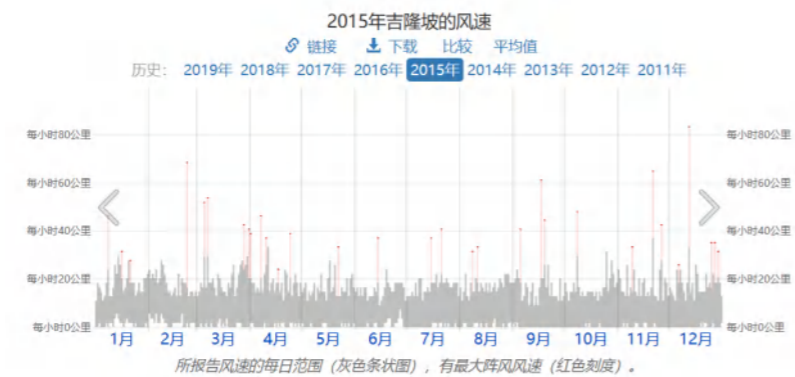

ADVANTAGES / 优势

① High safety / 安全性高

High vertical load-bearing capacity with fall-arrest protection

Fall arrest devices attached during climbing are independent, minimizing safety issues resulting from operational errors.

Protection against personnel and items being dropped is ensured by full sealing, including guide rails, corners, and protruding parts.

All components undergo rigorous testing, including extreme load tests and drop tests, to ensure safety in extreme conditions.

高竖向荷载承载力, 防坠落

爬升附着的防坠装置相互独立, 最大限度地减少因操作错误而导致的安全问题。

所有部件采用完全密封设计, 包括导轨、拐角和突出部分, 防止人员和物品掉落。

所有部件都经过严格的测试, 包括极限载荷和坠落测试, 以确保极端情况的安全性。

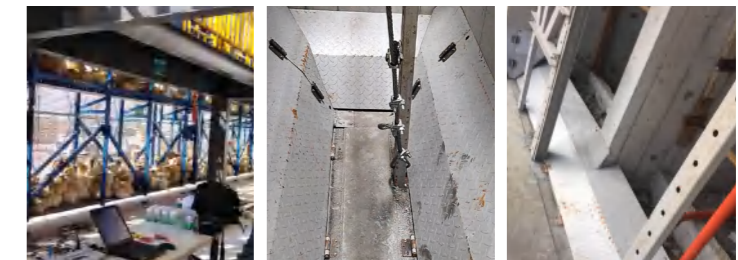

FEATURES AND ADVANTAGES 特点与优势

ADVANTAGES / 优势

② Higher productivity and cost efficient

- **Hydraulic drive system**
Compared to conventional climbing platform using electric hoists and electronically controlled, the cost is lower.
- **High component compatibility for easy management**
Main components do not exceed 10 types, achieving a universal compatibility rate of 95% or higher.
- The climbing operation is simple, the power unit has high reliability, and routine maintenance is convenient.
- Lower costs for disassembly, transportation, and labor due to the lightweight frame compared to regular steel climbing platforms.

③ Multi-functional

- Suitable for diverse shapes and heights of structure. Adjustable floor supports permit use on facades with both varying and constant inclinations.
- Platform boards and sealed flaps can be flush with floor levels.

② 经济适用性强

- **液压驱动装置**
与常规爬架采用电葫芦和电控相比，投入更低。
- **构件通用性强，便于管理**
主要组件不超过 10 种类型，且可达到 95% 或更高的通用兼容率。
- 爬升操作简单，动力装置可靠性高，日常维护保养方便。
- 与常规全钢爬架相比，架体重量轻，拆装、运输、劳务成本低。

③ 多功能

- 可以适用多种结构造型的结构楼，可实现标准立面、外倾立面、内倾立面等多种角度爬升。
- 平台板和密封翻板可平齐楼层位置。

PRODUCT COMPONENTS 产品构件组成

The protection screen consists of the climbing system, vertical main framework, scaffold body structure, and protection and sealing.

防护屏由爬升系统，竖向主框架，架体构架，防护和密封四个部分组成。

Suitable for the peripheral construction protection of high-rise and super-high-rise buildings.

主要适用于高层、超高层建筑的外围施工防护。

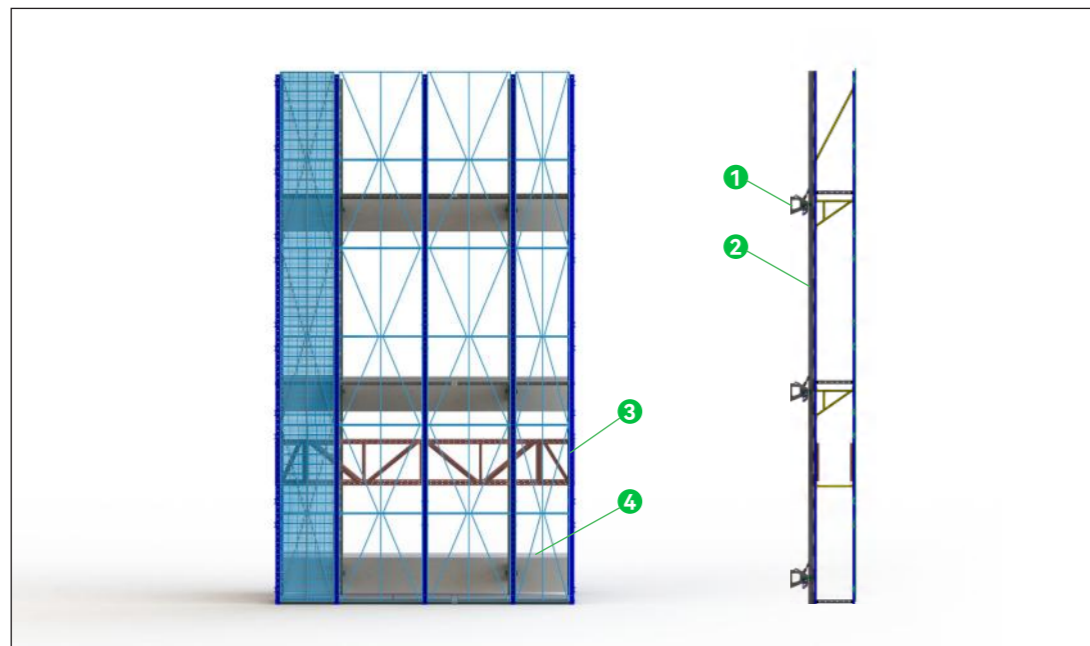

- 1 **Climbing system:** Embedded bolt, Attached support, Hydraulic cylinder, Lifting device, Hydraulic system.
爬升系统：埋件螺栓、附着支座、液压油缸、提升装置、液压系统；

- 2 **Vertical main framework:** Guide rail, Upright vertical pole, Triangular truss.
竖向主框架：导轨、外立杆、三角桁架；

- 3 **Structure of scaffold body:** Standard, Triangular truss, Walkway panel, Horizontal truss.
架体构架：立杆、三角桁架、走道板、水平桁架；

- 4 **Protection and sealing:** Perforated steel mesh panel, Sealed flap, Toe board.
防护和密封：冲孔钢板防护网、密封翻板、踢脚板。

PRODUCT COMPONENTS 产品构件组成

CLIMBING SYSTEM 爬升系统

Attached support, Hydraulic cylinder, Embedded bolt, Lifting device, Hydraulic system

附着支座、液压油缸、埋件螺栓、提升装置、液压系统

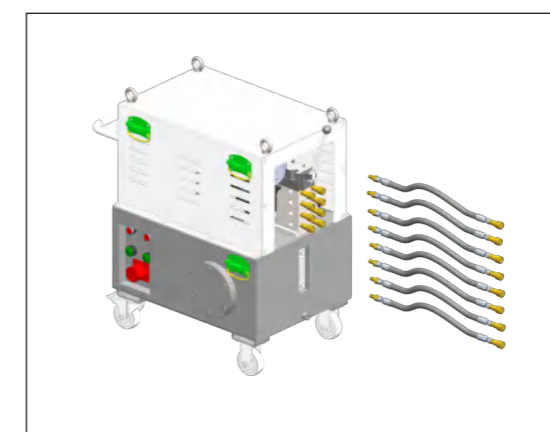
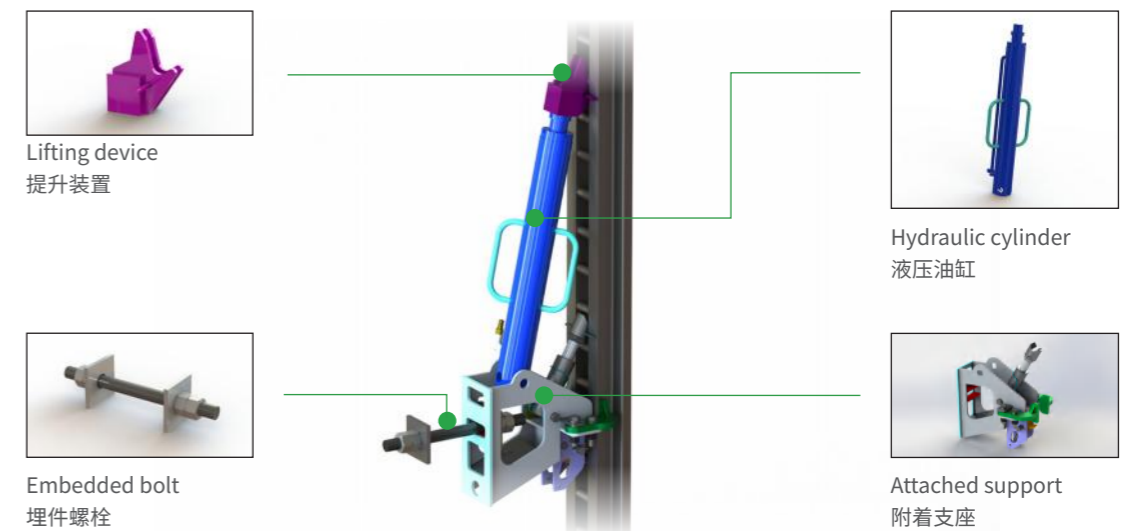

Hydraulic system 液压系统

The hydraulic system consists of a pump station (power device), hydraulic oil circuit, and other components. It can circulate for use in multiple sets of protection screen units. Hydraulic system configuration: One pump station drives four hydraulic cylinders, each with an inlet and an outlet hydraulic pipeline.

液压系统由泵站（动力单元）、液压油路等组成。一套液压系统可周转应用于多套防护屏单元的爬升。
液压系统的配置：最大1拖4。1个泵站驱动4个液压油缸，每个液压油缸有一进一出两个油路管道。

PRODUCT COMPONENTS 产品构件组成

VERTICAL MAIN FRAMEWORK 竖向主框架

Guide rail, Triangular truss, Upright vertical pole.

导轨、三角桁架、外立杆。

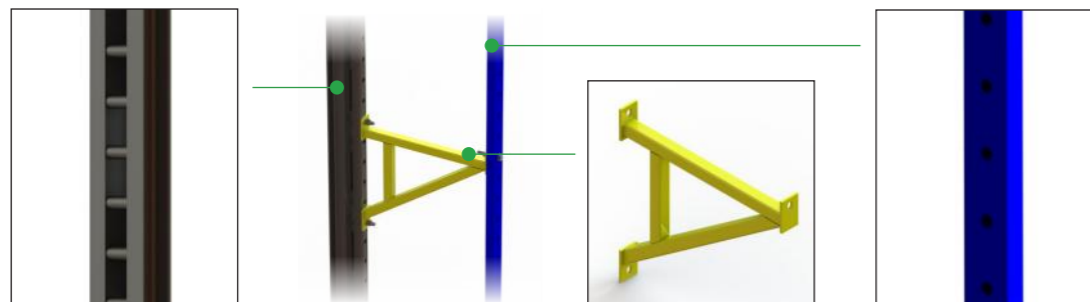

Guide rail: No. 8 channel steel, D28 round steel
导轨: 8# 槽钢、D28 圆钢

Triangular truss: 40×40×3mm square tube
三角桁架: 40×40×3mm 方管

Upright vertical pole: 80×40×3 mm rectangular tube
外立杆: 80×40×3mm 矩管

STRUCTURE OF SCAFFOLD BODY 架体构架

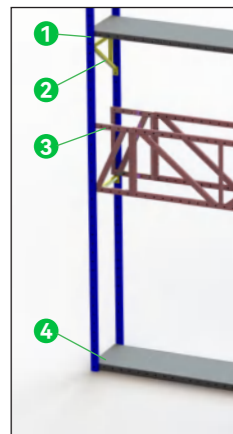

- 1 **Standard:** 80×40×3mm rectangular tube
立杆: 80×40×3mm 矩管

- 2 **Triangular truss:** 40×40×3mm square tube
三角桁架: 40×40×3mm 方管

- 3 **Horizontal truss:** 60×40×3mm rectangular tube, 40×40×3mm square tube
水平桁架: 60×40×3mm 矩管、40×40×3mm 方管

- 4 **Walkway panel:** 63×40×4mm angle steel, 2 mm checkered steel plate
走道板: 63×40×4mm 角钢、2mm 花纹钢板

PROTECTION AND SEALING 防护和密封

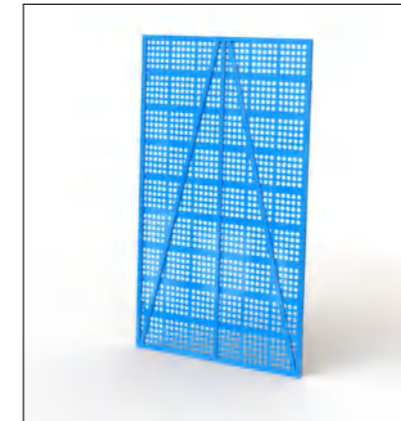

- 1 **Perforated steel mesh panel:** 20×20×2mm square tube, 0.7mm perforated steel mesh

冲孔钢板防护网: 20×20×2mm 方管, 0.7mm 冲孔钢板网

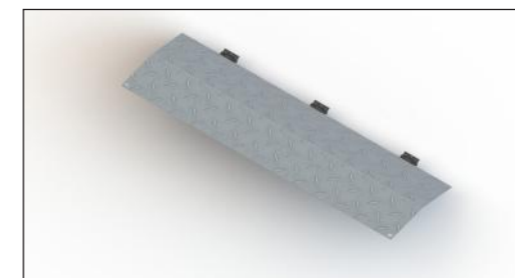
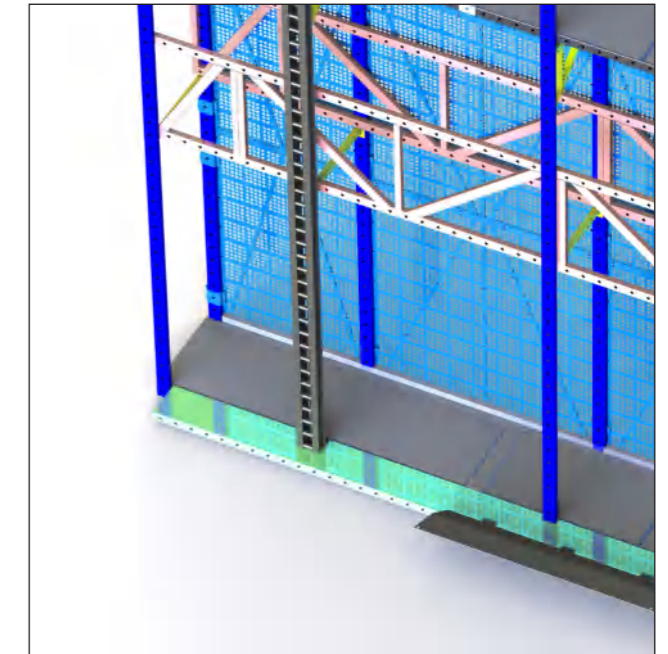

- 2 **Sealed flap:** t1.8 checkered steel plate
密封翻板: t1.8 花纹钢板



- 3 **Toe board:** 0.5 mm bent steel plate
踢脚板: 0.5mm 折弯钢板

PRODUCT COMPONENTS 产品构件组成

COMPONENTS 零部件



Triangular truss
三角桁架



Walkway panel
走道板



Hydraulic cylinder
液压油缸



Attached support
附着支座

SAMPLE FRAME 样架



Side-front view
侧前方视角



Front view
正前方视角



Side view
侧边视角

SURFACE TREATMENT OF COMPONENTS 产品构件表面处理工艺

GALVANIZED SURFACE

表面镀锌



Corrosion grade:

C5 (Coastal Areas)

腐蚀等级:

C5 (沿海地区)



Quality inspection standard:

Finished galvanization $\geq 85\mu\text{m}$, pipe material $\geq 70\mu\text{m}$

质检标准:

成品镀锌 $\geq 85\mu\text{m}$, 管材 $\geq 70\mu\text{m}$



Reference standards:

GB/T 13912, EN10240

参考标准:

GB/T 13912, EN10240



Initial maintenance interval in design:

≥ 10 years

设计初次维护周期:

≥ 10 年

E.g., If a project cycle is 1 year, surface rust prevention can serve for usage and maintenance in at least 10 projects.

例如: 若一个项目周期 1 年, 则表面镀锌可以保持不少于 10 个项目的使用再维护。

SYSTEM FEATURES

产品技术参数

S/N 序号	Item 项目	Unit 单位	Specification 设计值	Remark 备注
1	Framework height 架体高度	m	8~15	Adapting framework height to project conditions 根据项目实际情况调整架体高度
2	Framework width 架体宽度	m	0.6-1.2	Standard platform board width: 0.6m 标准平台板宽度为 0.6m
3	Machine position affecting width 机位影响宽度	m	≤ 5	Total length varies with machine position count 单片机位数不同整片架体长度不同
4	Single unit weight 单机位重量	T	1.5	Calculating based on a 2.5-level protection screen, with a machine position affecting width of 5m 按 2.5 层防护屏, 机位影响宽度 5m 计算
5	Rated lifting capacity of the power unit 动力装置额定顶升载荷	T	3.5-7	Hydraulic cylinders, pump station 液压油缸、泵站
6	Power unit capacity 动力装置功率	KW	1.5	Voltage: 380V/415V, Frequency: 50Hz 电压 380V/415V, 频率 50Hz
7	Single lift height of hydraulic cylinder 油缸单次顶升高度	m	0.3	Effective lift height: 0.3m, Total cylinder stroke: 0.42m 有效顶升高度 0.3m, 油缸总行程 0.42m
8	Lifting speed 顶升速度	m/min	0.3	
9	Time for lifting one level 顶升一层时间	min	10	Calculating based on a 3m floor height 按层高 3m 计算
10	Platform load capacity 平台允许载荷	kN/ m ²	2	Operating on a two-level platform (200kg/m ² load capacity per level) 按 2 层平台作业 (每层平台每平方米堆载 200kg)

02.

PRINCIPLES AND PROCESS OF CLIMBING 爬升原理与流程

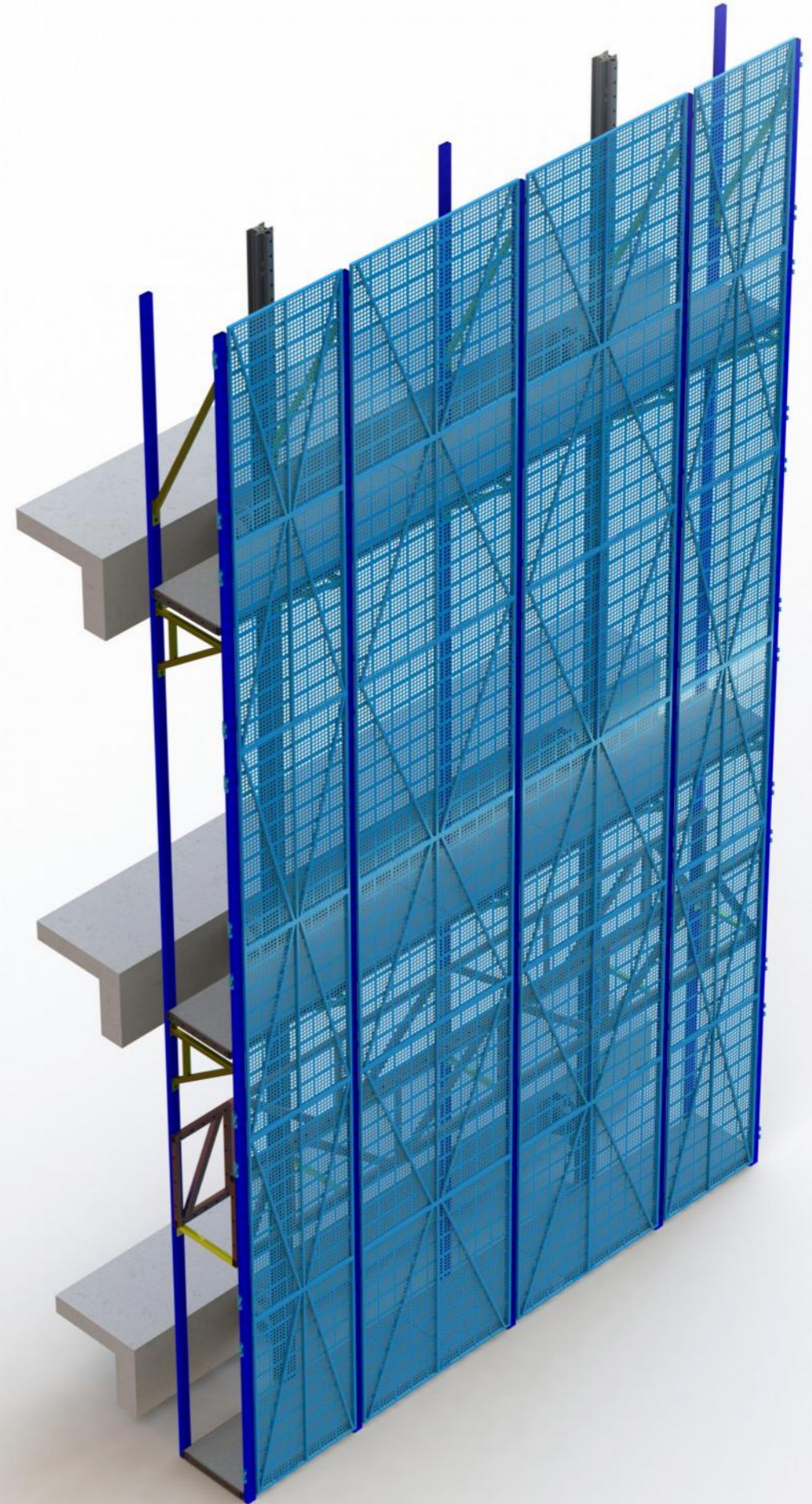

PRINCIPLES OF CLIMBING 爬升原理

INITIAL PHASE

起始阶段

Installation of hydraulic cylinder and lifting device on attached support.

在附着支座上安装液压油缸和提升装置。

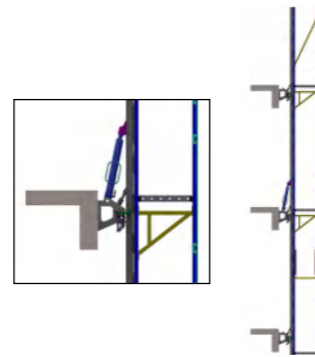

LIFTING PROCESS

爬升阶段

The hydraulic cylinder repeatedly extends and retracts, gradually lifting the protection screen.

液压油缸反复伸长和收缩，将防护屏一步一步顶升到位。

The hydraulic cylinder extends, and the lifting device pushes the protection screen up by one stroke, completing the extension process. The attached support unloads and locks the protection screen in position. The hydraulic cylinder then retracts, completing the retraction process.

液压油缸伸长，提升装置顶升防护屏上升一个行程，完成伸长过程。附着支座将防护屏卸荷固定位置，液压油缸收缩，完成收缩过程。

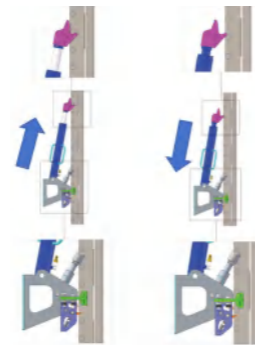

REACHING FINAL POSITION

爬升到位

Removing the hydraulic cylinder and lifting device.

移走液压油缸和提升装置。

After lifting the protection screen to the design elevation, remove the hydraulic cylinder after unloading.

防护屏顶升至设计高程，卸荷之后移走液压油缸。

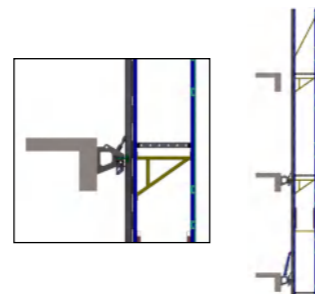

PROCESS OF CLIMBING 爬升流程

GROUND ASSEMBLY PROCESS

地面组装

1 Prepare the site, level the ground, lay foundation blocks, and arrange guide rails as per drawings. Install connecting seat.

搭设拼装架体用操作架，找平并放置平整，在操作架上放置导轨、内立杆、内排水平桁架，并将所列构件拼装连接成整体；

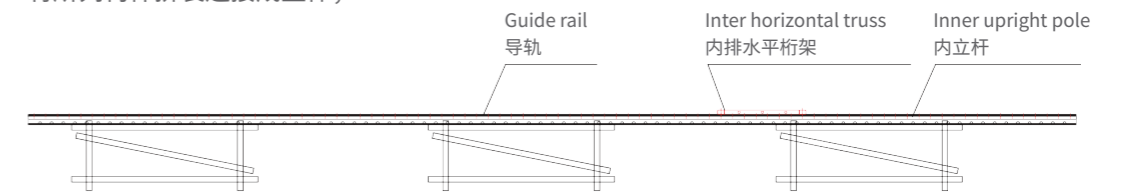

2 Install the triangular truss, then install the bottom walkway panel, and install the upright vertical pole to stabilize the walkway panel (note that the bolts of the upright vertical pole should not be fully tightened).

安装一处主框架三角桁架后，安装底部走道板，安装外立杆使底部走道板稳定（注意外立杆螺栓不用打紧）；

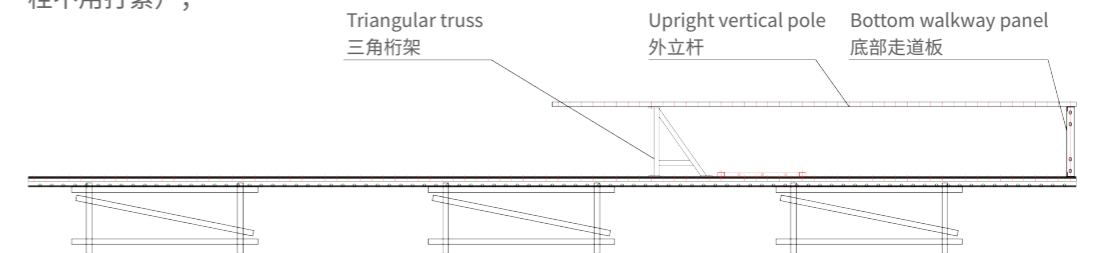

3 Continue the procedures in Step 2, install the Step 3 walkway panel, and tighten all bolts after installation.

继续安装第二步、第三步走道板，安装完后打紧螺栓；

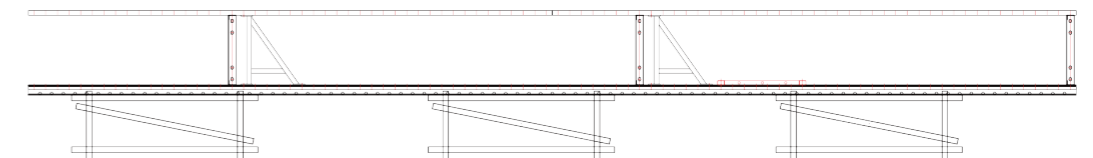

PROCESS OF CLIMBING 爬升流程

GROUND ASSEMBLY PROCESS

地面组装

- 4 Install all triangular trusses, upright vertical poles, and external horizontal trusses to complete the installation of the main frame.

安装全部三角桁架、外立杆、外排水平桁架，完成整体框架安装；

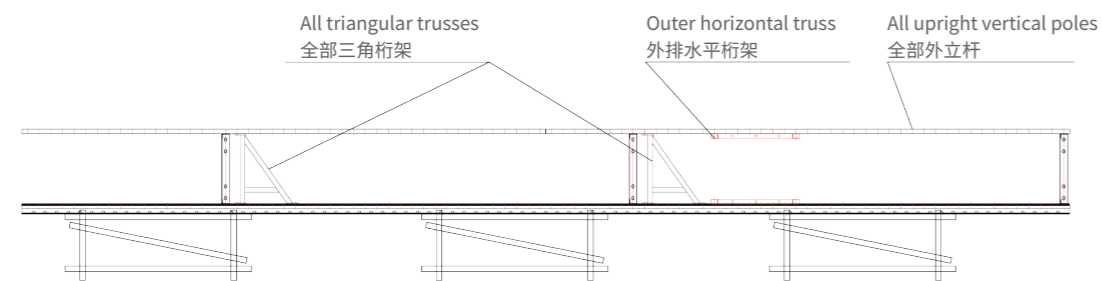

- 5 Install the perforated steel mesh panel and internal guard plate in sequence, and wait for tower crane lifting. Do not install the perimeter mesh panel in the lifting area to avoid damage.

依次安装防护网，内沿板，等待塔吊吊装，注意起吊周边防护网不安装，避免损坏防护网；

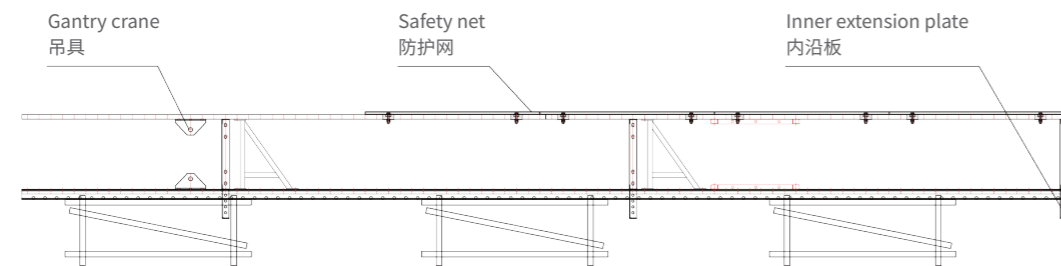

- 6 Ensure the bottom end of the guide rail touches the ground, and slowly adjust the structure to a vertical position.

架体底部导轨触地，缓慢调整竖直吊起；

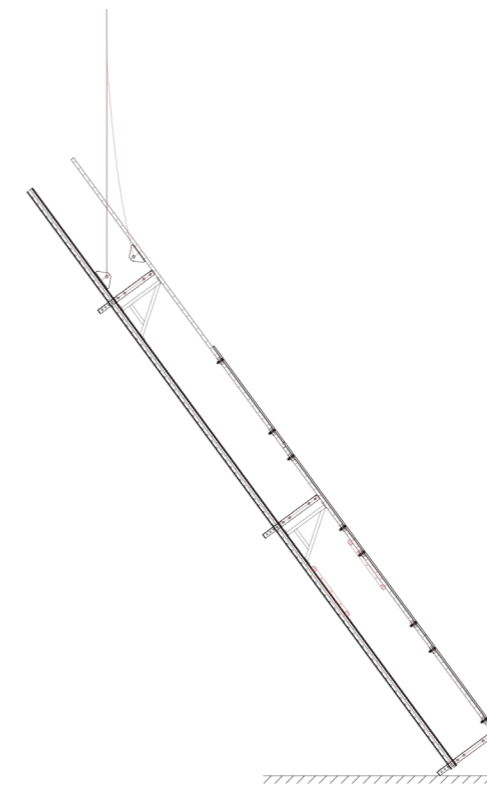

- 7 After lifting the protection screen to the tower crane lifting level, adjust the displacement plate of the attached support to align with the guide rail. Adjust and install the top canopy, unload by lowering the cranes wire rope and complete the installation of the bottom sealed flap and top mesh closure.

起吊钢丝绳下降进行卸荷，完善底部防护翻板及顶部网片。

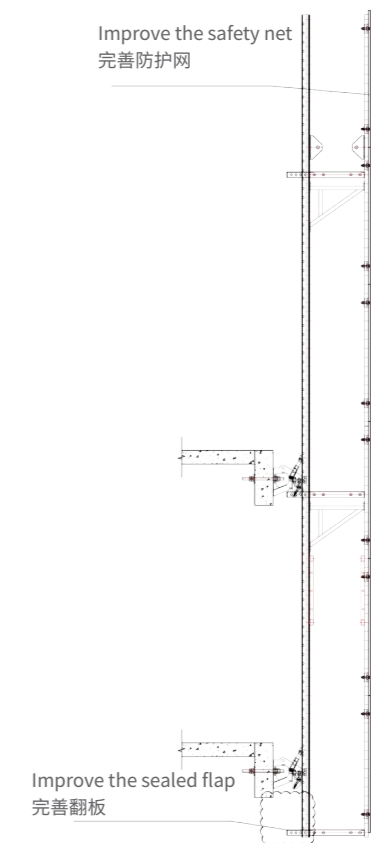

PROCESS OF CLIMBING 爬升流程

INSTALLATION PROCESS

安装阶段

- 1 The attachment floors required for the protection screen have been completed. After formwork removal, install at least two layers of attached supports.

防护屏开始使用附着楼层已做好，拆模安装好至少 2 层附着支座；

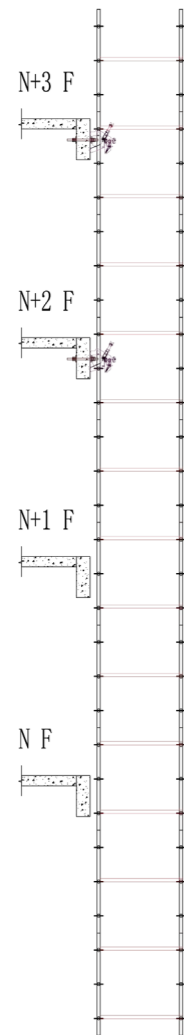

- 2 Remove the protective scaffolding around the perimeter of the attached floor.

拆除附着楼层外围防护脚手架；

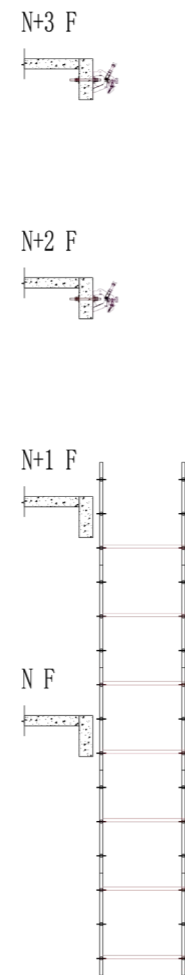

- 3 The tower crane lifts the protection screen frame for installation and attachment to the building.

塔吊吊运防护屏架体进行安装附着。

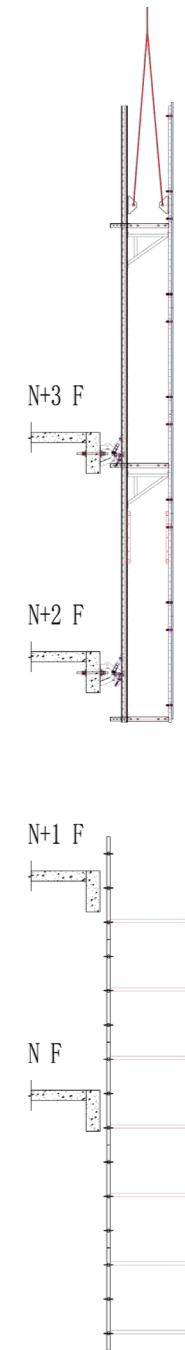

PROCESS OF CLIMBING 爬升流程

LIFTING PROCESS

爬升阶段

- ① During the construction of the current floor level (Using 2 sets of support).
在建层施工中（使用状态 2 道支座）；

- ② After the construction layer is completed and the formwork is removed, the top attached support is installed.
在建层浇筑完成后拆模，安装顶层附着支座；

- ③ Remove the first attached support and relocate it to the top floor.
拆除第 1 道附着支座周转至顶层；

- ④ During the lifting of the frame (Using a hydraulic device for lifting).
架体提升中（使用液压装置顶升）；

- ⑤ Lift the frame into position, then continue construction of the current floor level.
提升到位，在建层施工中。

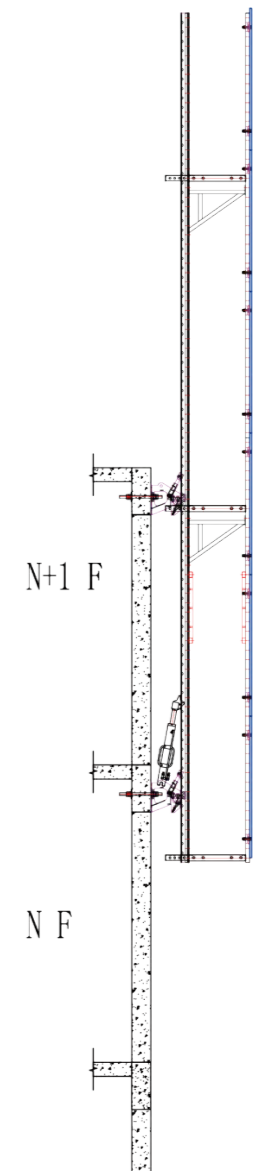
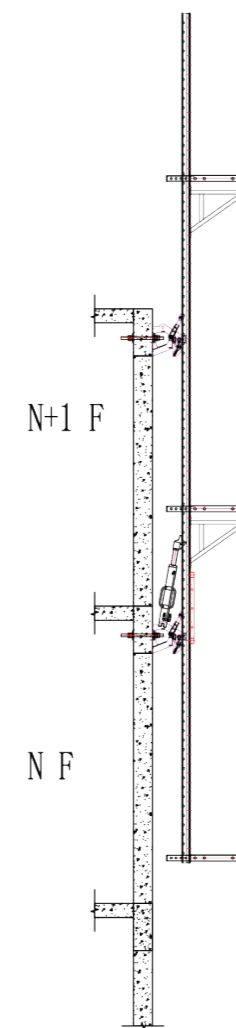
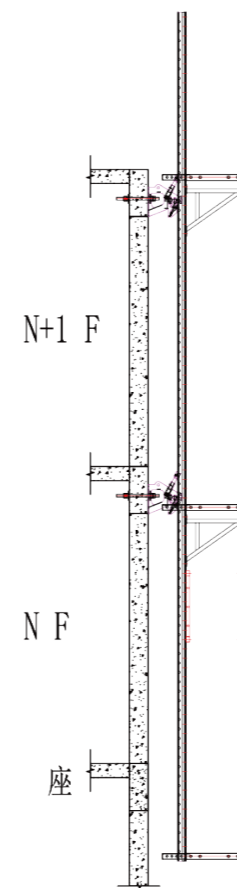
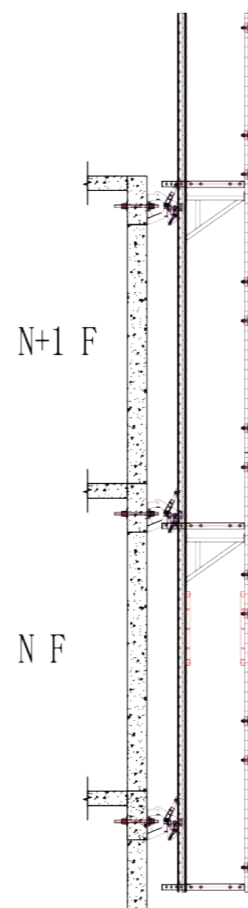
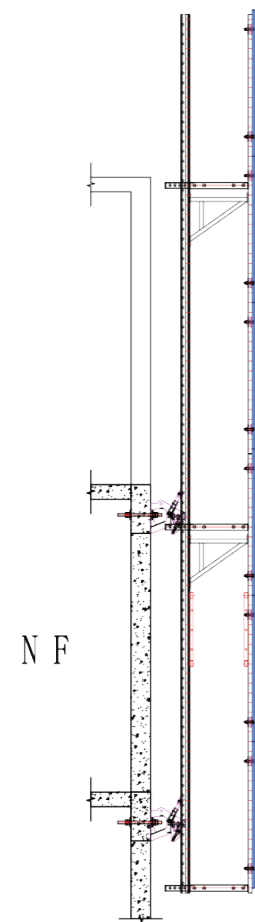

PROCESS OF CLIMBING 爬升流程

DISMANTLING PROCESS

拆除阶段

- 1 After the roof layer is completed, the structural construction is finished, and the protection screen can be removed.

施工完成屋顶层后，结构施工完毕，防护屏可进行拆除作业；

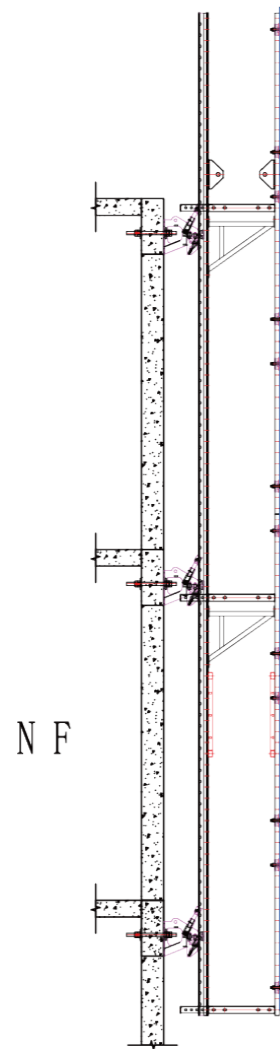

- 2 First, use ropes to secure the attached supports and attached bolts onto the frame. Then, lift the protection screen with the tower crane for pre-tightening. Remove the nuts of the attached bolts from the internal side of the structure.

先用绳子绑扎附着支座及附着螺杆固定在架体上，塔吊吊起防护屏进行预紧，从结构内侧拆除附着螺杆螺母；

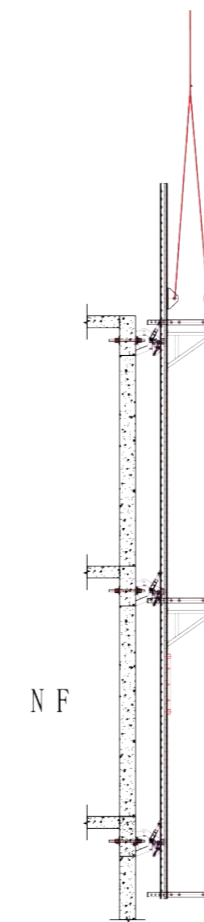

- 3 The protection screen unit is lifted out as a whole and the hole is sealed.

防护屏单元进行整体吊离，封堵洞口。

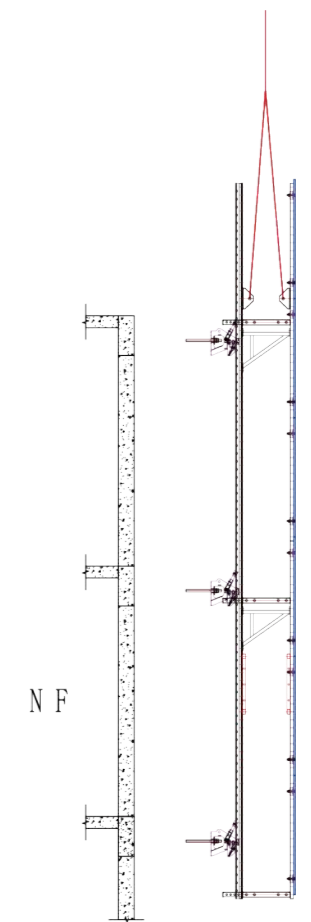

03.

SPECIAL POSITION SOLUTIONS 特殊位置处理方式

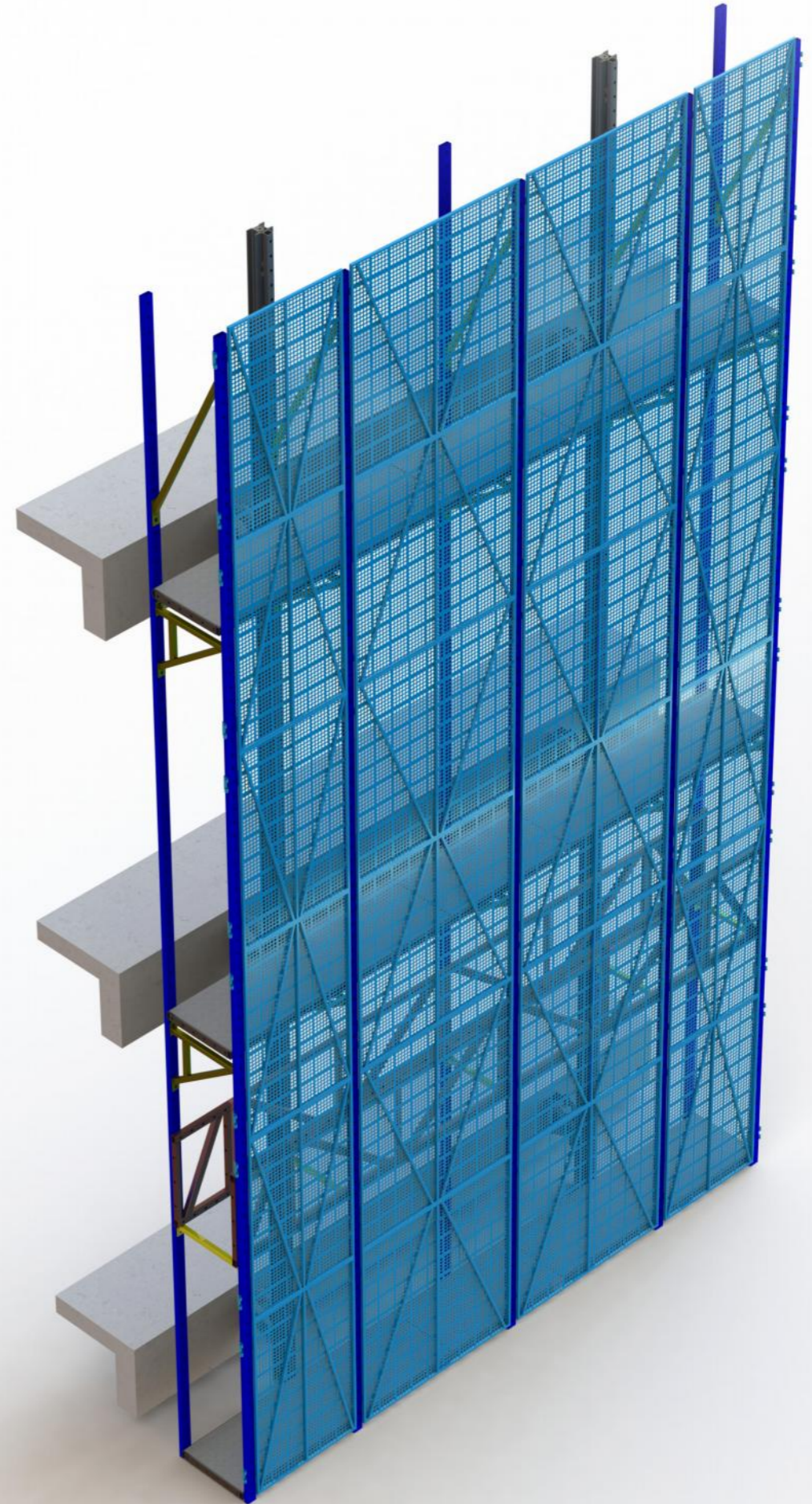

THE FRAMEWORK STRUCTURE AT THE LOCATION OF THE TOWER CRANE ATTACHED ARM 塔吊附臂位置处架体构造

Higher framework to avoid interference with the tower crane attached arm.
较高架体避免干涉塔吊附臂

较高架体避免干涉塔吊附臂

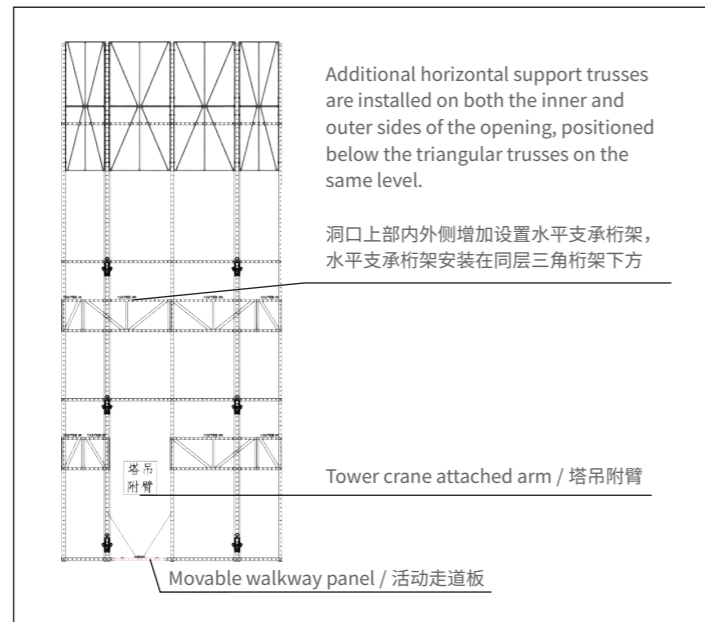

Lower framework to avoid interference with the tower crane attached arm.
较矮架体避免干涉塔吊附臂

较矮架体避免干涉塔吊附臂

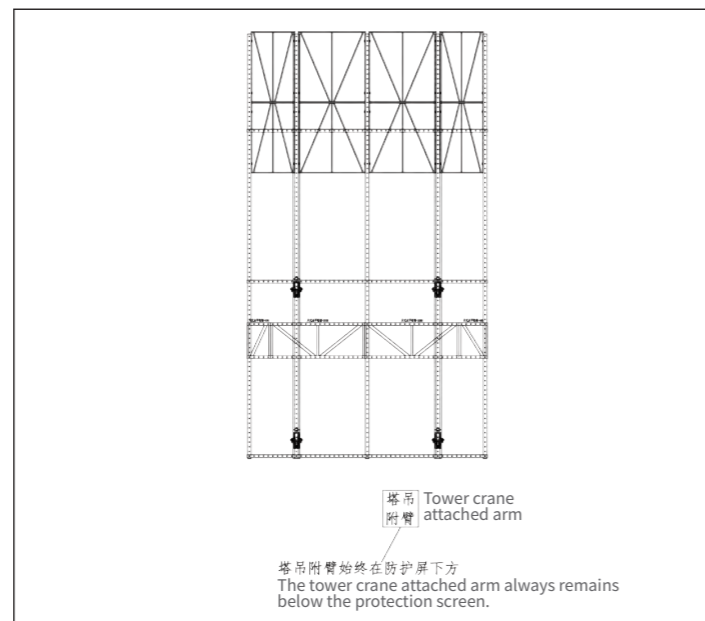

THE FRAMEWORK STRUCTURE AT THE LOCATION OF THE CONSTRUCTION ELEVATOR 施工电梯位置处架体构造

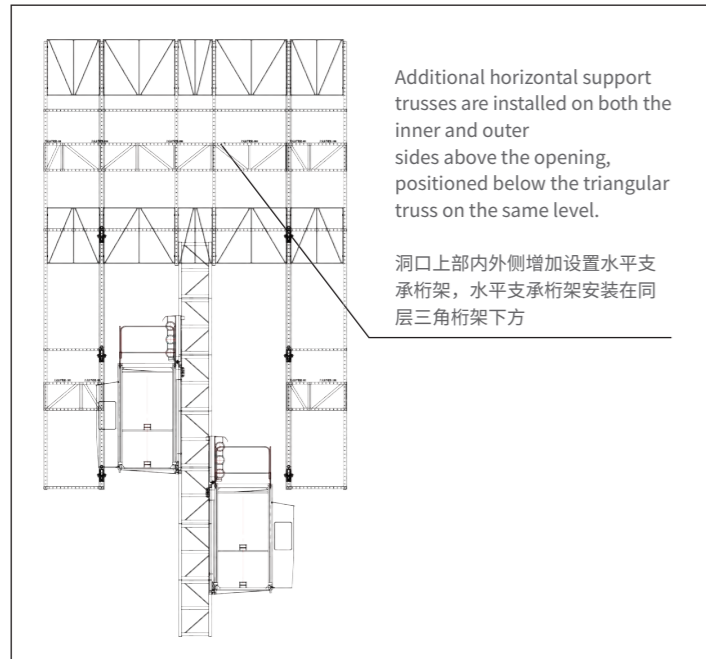

Note: Protection screen covers the main structure up to 2.5 levels, preventing the construction elevator from entering the framework

注意：防护屏覆盖主体结构 2.5 层的，不建议施工电梯进入架体。



THE FRAMEWORK STRUCTURE AT THE LOCATION OF THE LOADING PLATFORM 卸料平台位置处架体构造

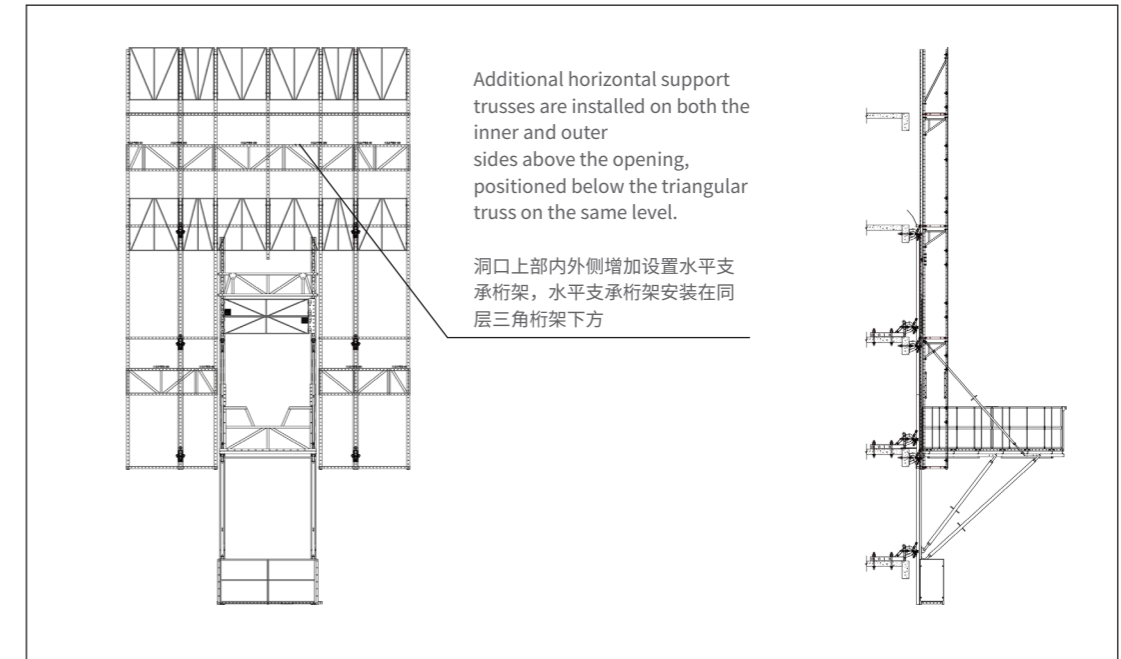

THE BAY WINDOW UTILIZES ELEVATED COMPONENTS WITH INCLINED TENSION ATTACHMENT 飘窗位置采用加高件斜拉附着

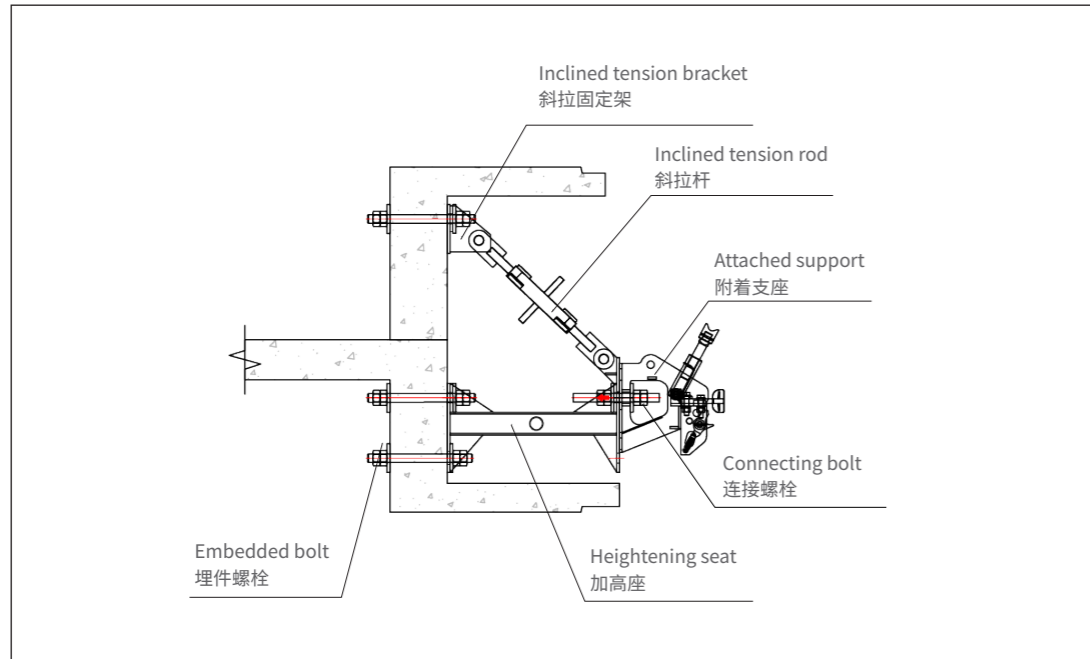

FLOOR INCLINED TENSION ATTACHMENT 楼板面斜拉附着

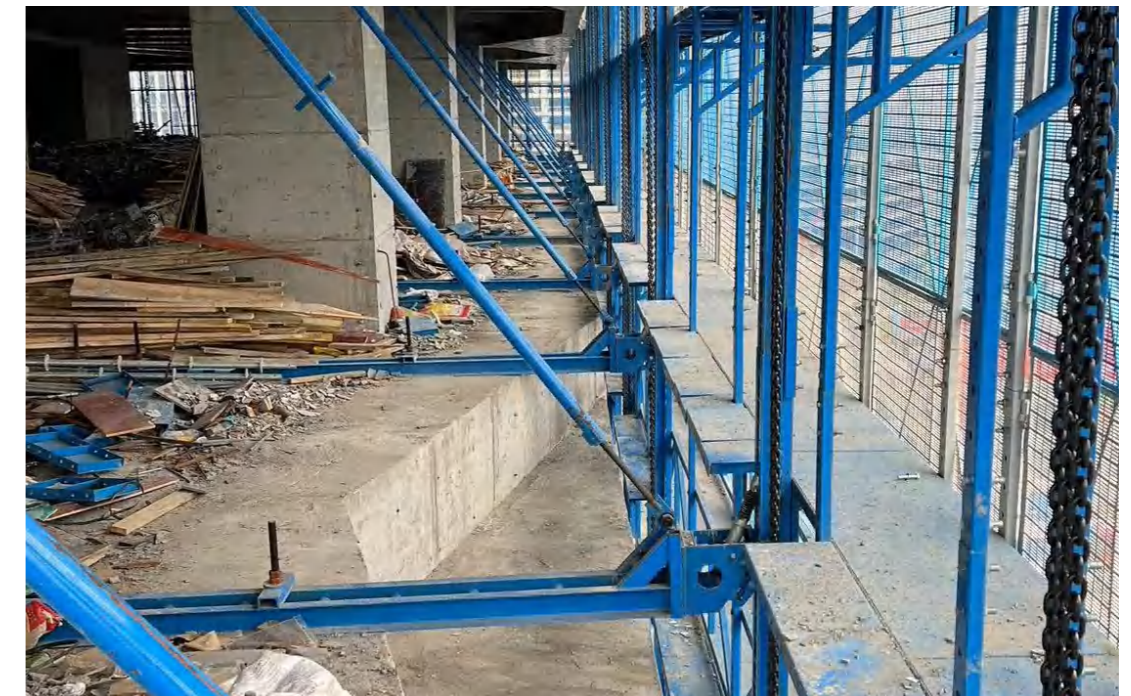
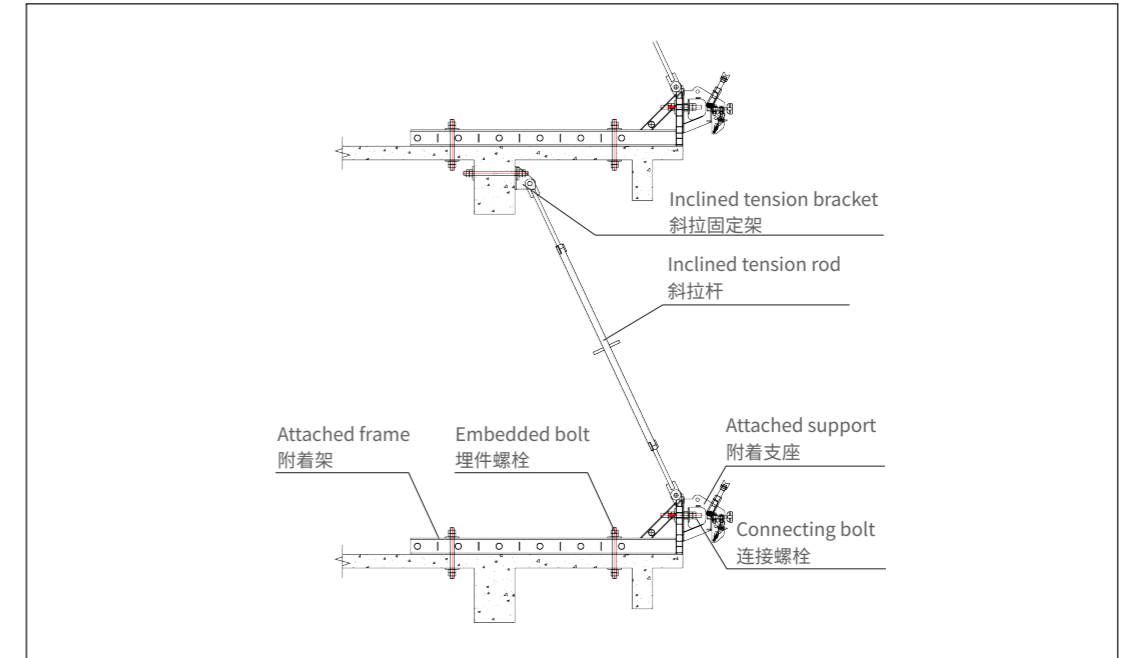

FLOOR WITH ELEVATED INCLINED TENSION ATTACHMENT 楼板面垫高斜拉附着

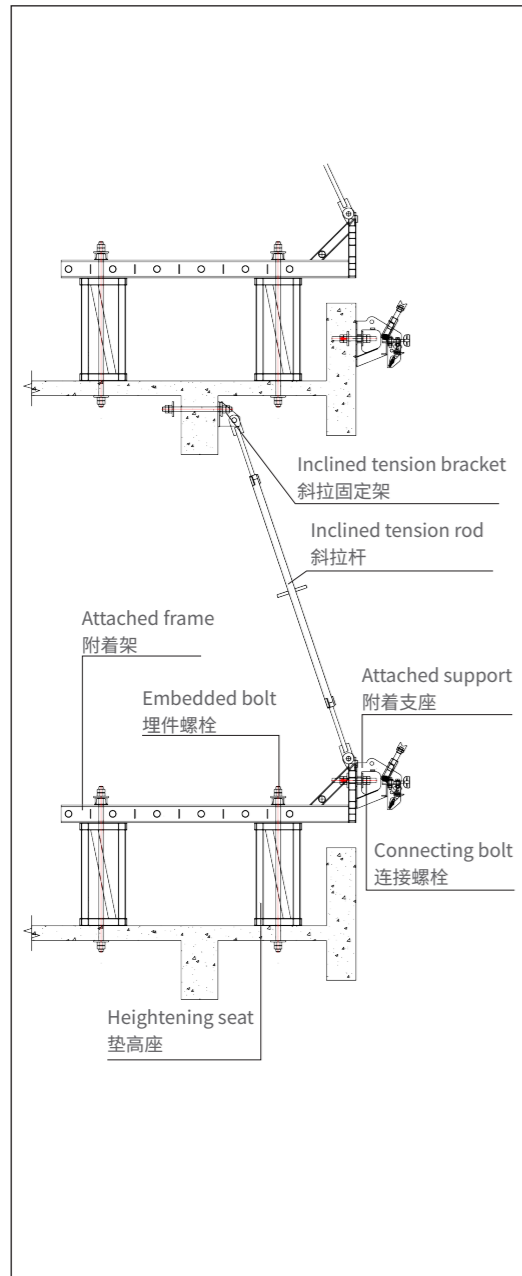

STRUCTURE OVERHEAD OR INTERNALLY RETRACTS AND EMBEDS WITH STEEL COLUMNS ATTACHMENT 结构架空或内缩内置采用钢构柱附着

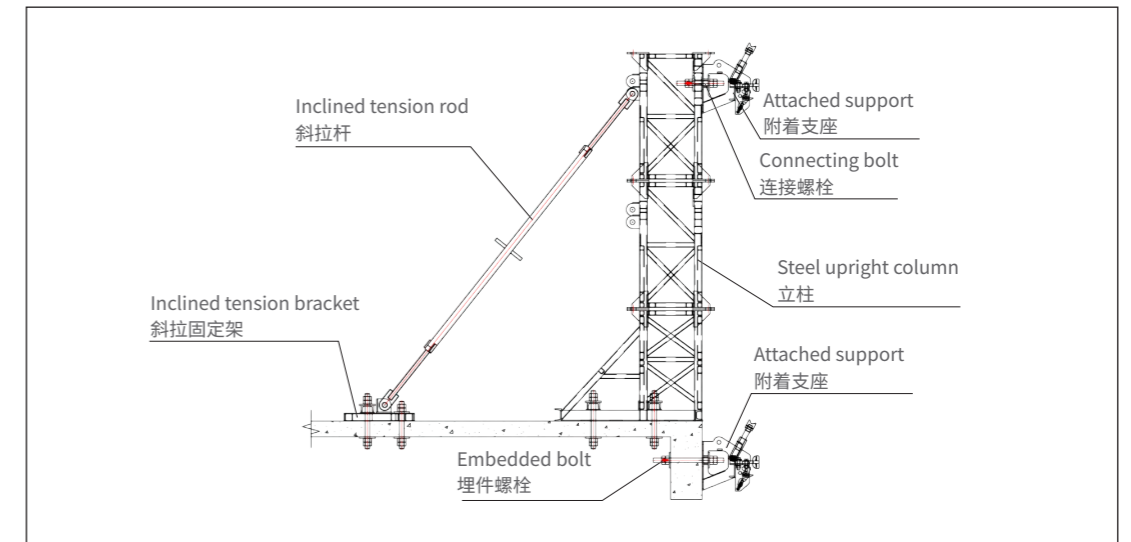

AT THE LOCATION OF LARGE STEEL COLUMNS IN STEEL STRUCTURE PROJECTS, HOOP ATTACHMENTS ARE INSTALLED

钢结构项目大钢柱处设置抱箍附着

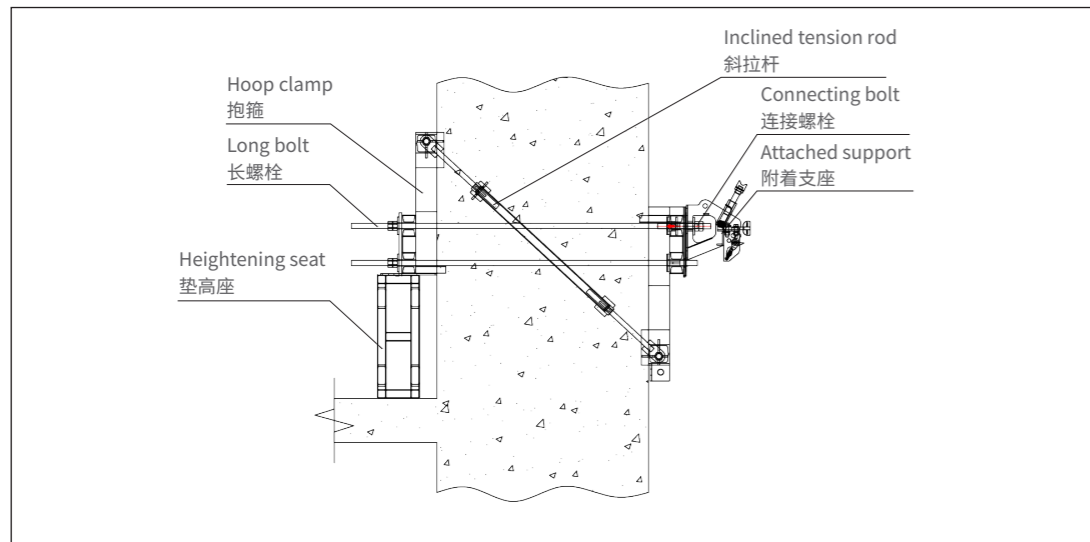

KNOTTING MEASURE FOR TOP CANTILEVER OF THE STRUCTURE

架体顶部悬臂拉结措施

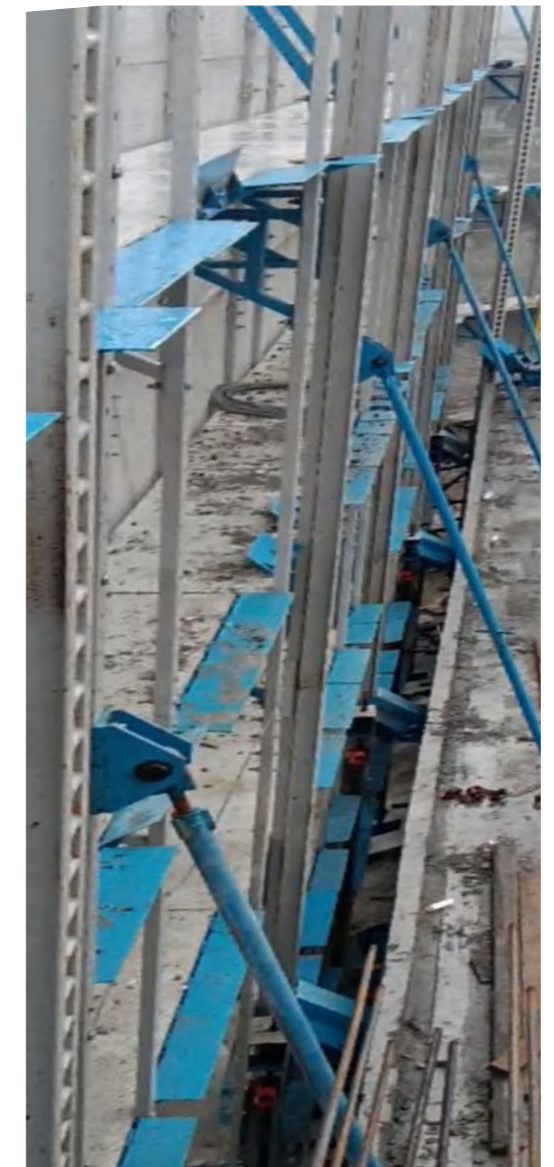
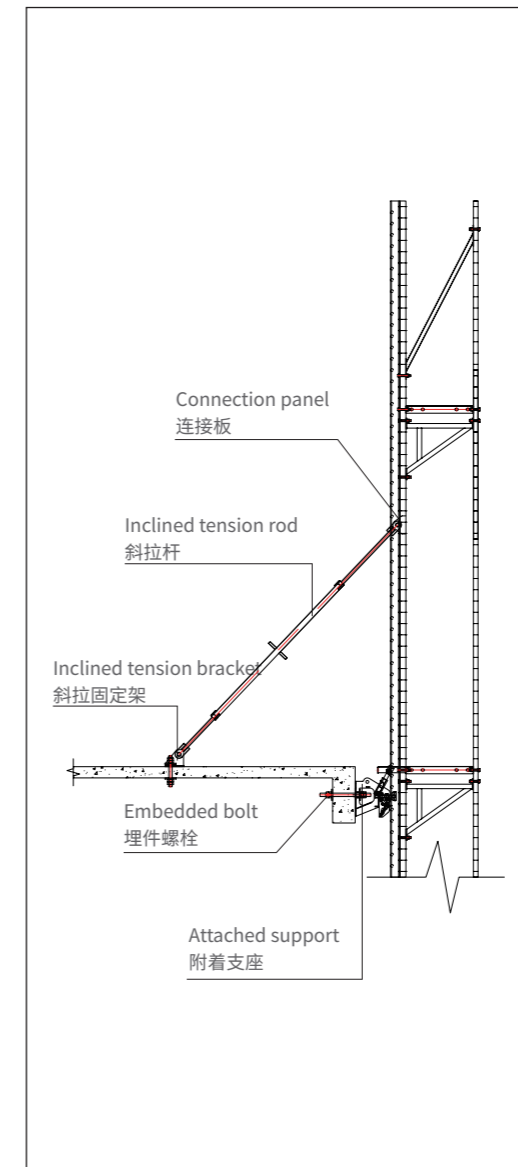

ATTACHMENT OF THE INCLINED FACADE 倾斜外立面的附着措施

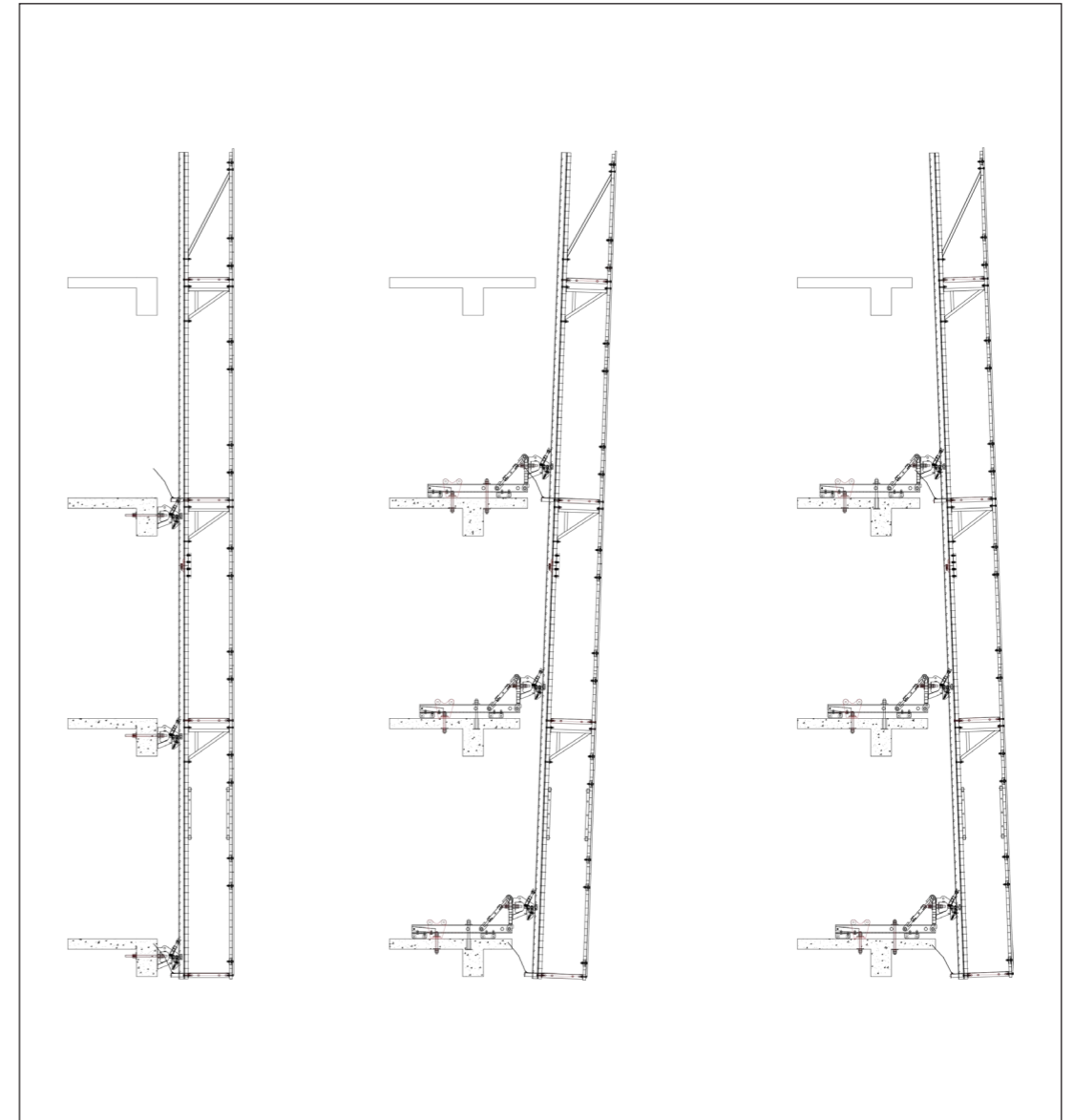
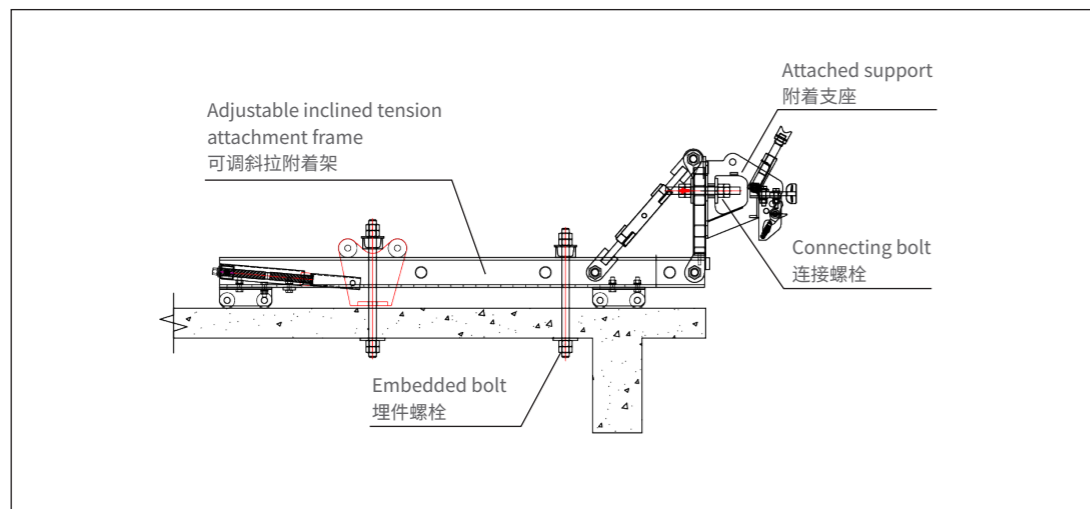

04.

PROJECT
CASES
项目案例



SINGAPORE PREFABRICATED RESIDENTIAL PROJECT 新加坡预制住宅项目

Number of Buildings / 楼栋数量: 5

Number of Protection Layers / 防护层数: 2.5



Number of Buildings / 楼栋数量: 5

Number of Protection Layers / 防护层数: 2.5



SINGAPORE COMMERCIAL BUILDING PROJECT 新加坡商业建筑项目

Number of Buildings / 楼栋数量: 2

Number of Protection Layers / 防护层数: 2.5

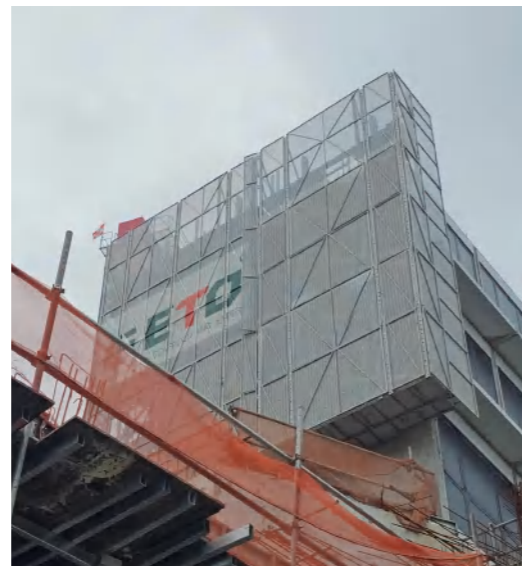

MALAYSIA RESIDENTIAL BUILDING PROJECT 马来西亚住宅楼项目

Number of Buildings 楼栋数量: 2

Number of Protection Layers 防护层数: 2.5



MALAYSIA APARTMENT PROJECT 马来西亚公寓楼项目

Number of Buildings / 楼栋数量: 2

Number of Protection Layers / 防护层数: 2.5



SOUTHEAST ASIA APARTMENT PROJECT 东南亚公寓项目

Number of Buildings / 楼栋数量: 2

Number of Protection Layers / 防护层数: 2.5



SOUTHEAST ASIA OFFICE & APARTMENT PROJECT 东南亚办公楼与公寓项目

Number of Buildings / 楼栋数量: 2

Number of Protection Layers / 防护层数: 2.5

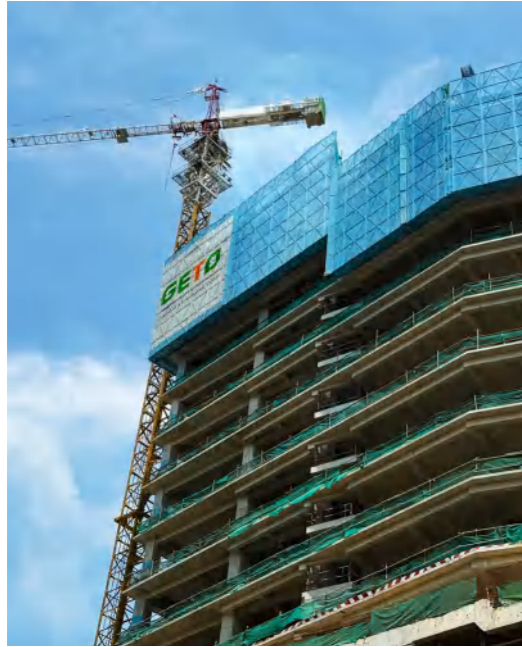

GETO Group

Headquarters:

Greater Bay Area—No. 13 Heqing Road, Tsuihang New District, Zhongshan City, Guangdong Province

Southern China Production Base I :

Cuishan Lake Science and Technology Park, Kaiping, Jiangmen City ,Guangdong Province

Southern China Production Base II :

Huizhou Industrial Transfer Industrial Park, Huizhou City, Guangdong Province

Eastern China Production Base I :

Guangchang Industrial Park, Fuzhou City, Jiangxi Province

Central China Production Base:

Hi-tech Industry Development Zone, Xianning City, Hubei Province

Northern China Production Base:

China Aluminium Industrial Park, Linqu, Weifang City, Shandong Province

Southwest China Production Base:

Modern Manufacturing Industrial Park, Tongnan High-Tech District, Chongqing City

Northwest China Production Base:

The Circular Economy Park, Anding District, Dingxi City, Gansu Province

Hainan Production Base:

Gold Medal Port Industrial Park, Lingao County, Hainan Province

ASEAN Production Base:

Negeri Sembilan, Malaysia

Singapore Production Base :

West Region, Singapore

Saudi Arabia Production Base :

Riyadh, Saudi Arabia

Contact

Sales Hotline: 0086-760-88589004

E-mail: geto_market@geto.com.cn

Website: www.getoformwork.com

20251210V1

